



Single Run 60

Internal Top Hung Sliding System

Single Run 60 is a simple to use sliding door system for residential and light commercial use suitable for internal doors up to 60kg, both for internal doors and wardrobes.

With an aluminium top track, nylon wheels with sealed bearings and an optional softclose divide, the system is extremely reliable, quiet and smooth to operate.

Bottom guidance options include a full length channel in the floor with door mounted guides, a floor mounted guide that runs in a sawcut groove in the bottom of the door, or a wall mounted roller guide running in an inverted channel within the bottom of the door. A captive guide set requiring no door preparation is also available.

We can also offer 2 hanger variants, a standard option that works best in conjunction with a pelmet, or a zero headroom option that allows for a very small 3mm gap between top of door and bottom of track, ideal for recessed track applications.



Hardware Components



60DS
Door Stop



91
Track Bracket



60A
Top Track



60CS
Clip Stop



B4742.SS
Wedge Stop



94P
Bottom Guide Channel



60SCT
Softclose



924-CA48
Interlock

Common Door Layouts

Single Panel Sliding behind Fixed



Double Panel Bi-Parting



Multiple Telescopic Panels Sliding behind Fixed Panel

Fixed Panel

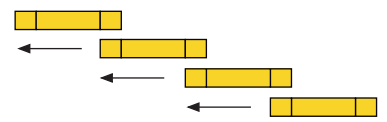

Typical Wardrobe Options

2 Doors Bi-Passing

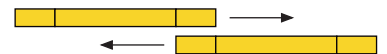

3 Doors Bi-Passing



Top Hanger Options

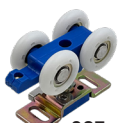

607
Standard Top
Fix Hanger



609
Zero Clearance
Top Hanger

Bottom Guide Options



106E/94
94 Guide
Roller



113/94
94 Guide Roller
Corner Fix



106A/94
Wall Mounted
Guide

Internal Only

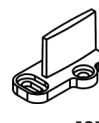

101N
Sawcut Floor
Guide

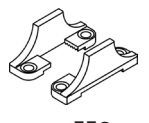

55G
Nylon Captive
Floor Guide Set

Maximum Weight (kg)
60

Maximum Width (mm)
1200

Maximum Height (mm)
2400

Panel Thickness (mm)
19+ (standard) / 28+ (zero clearance)

Typical Layouts	Runs Of 60A Top Track	Top Hanger Selection		Bottom Guidance Selection					Optional Hardware can be adjusted based upon individual applications			
		607 Standard Hanger	609 / 610 Zero Clearance Hanger	106E/94 Door Mounted Guides	106A/94 Wall Mounted Guide	101N Sawcut Floor Guide	55G Captive Nylon Floor Guide Set	94P Runs Of Bottom Guide Channel	924-CA48 Interlock	B4742SS Door Stop	456R Flush Bolts Locking or Non-Locking	401 Flush Pulls
1 Door Sliding	1	2	2	2	1	1	1	1	1	1	1	2
2 Doors Bi-Parting	1	4	4	4	2	2	2	1	2	2	2	4
2 Doors Bi-Passing	2	4	4	4	N/A	2	2	2	0	0	2	2
3 Doors Bi-passing	2	6	6	6	N/A	3	3	2	0	0	3	4
2 Door Telescopic	2	4	4	4	1	N/A	N/A	2	2	2	2	3
3 Door Telescopic	3	6	6	6	2	N/A	N/A	3	3	3	3	4
Additional Notes	Available in lengths of 2000mm, 2500mm, 3000mm, 3500mm, 4000mm, 5000mm and 6000mm	609 x 2 for non Softclose application. 609 x 1 + 610 x 1 with Softclose	2no Guide rollers place at each end of the door You will also require 94P guide channel to recess into the floor for the whole width of the opening	Single wall mounted guide placed so that it is always in contact with the door and hidden from view. Requires 94P guide channel to be inverted and recessed into bottom of the door.	Single floor mounted guide placed so that it is always in contact with the door and hidden from view. Requires a sawcut groove on the bottom of the door.	Captive guide set that is placed either side of the door if no door preparation is required.	Available in lengths of 1000mm, 2000mm, 2500mm, 3000mm, 3500mm, 4000mm, 5000mm and 6000mm	Required to both stop the door and for telescopic panels to catch the doors when opening.				

Standard Hanger End Elevation

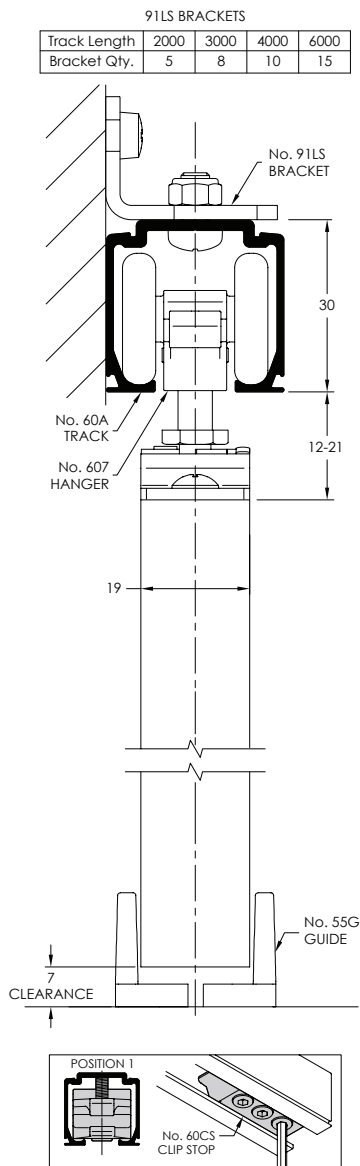

Zero Clearance Hanger Details

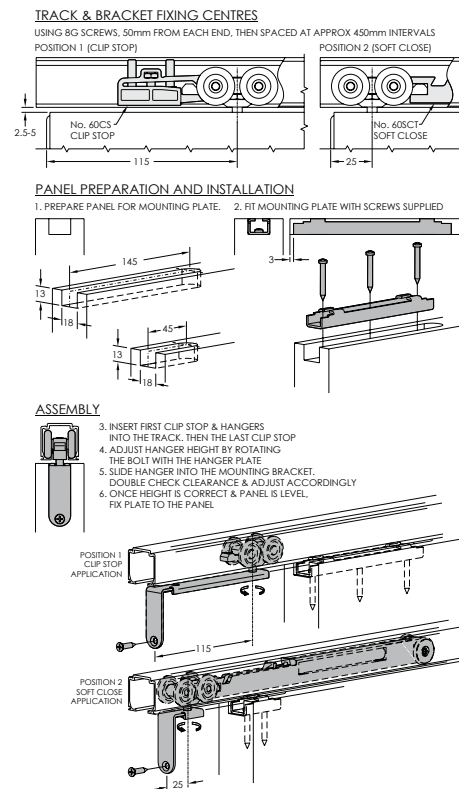

Bottom Guide Alternatives

