



# Single Run 120

## Top Hung Sliding System

Single Run 120 is a high quality sliding door system for heavy residential and commercial use suitable for internal and external doors up to 120kg.

With an aluminium anodised top track and nylon grooved wheels with sealed bearings the system is extremely reliable, quiet and smooth to use.

With multiple bottom guidance options, any design of door or floor can be accommodated.

Softclose is also available for internal doors up to 100kg ensuring safety is paramount when using in areas with children or the elderly.

We can also offer 2 hanger variants, a standard option that works best in conjunction with a pelmet, or a zero headroom option that allows for a very small 3mm gap between top of door and bottom of track, ideal for recessed track applications.

### Hardware Components

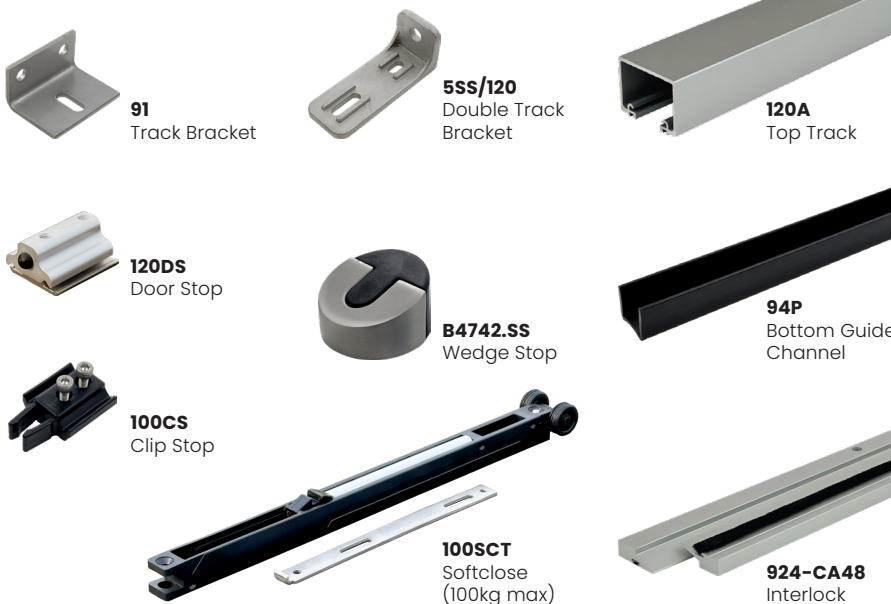

### Common Door Layouts

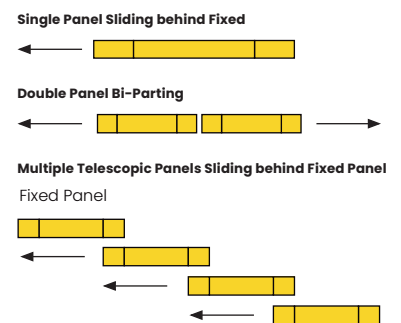

### Typical Wardrobe Options

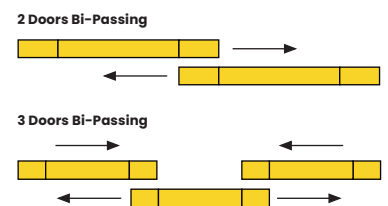

### Top Hanger Options

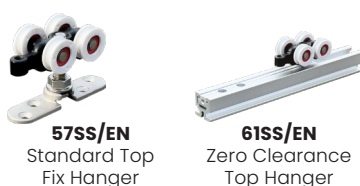

### Bottom Guide Options



### Internal Only

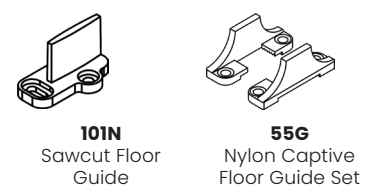

Maximum Weight (kg)  
**120**

Maximum Width (mm)  
**1500**

Maximum Height (mm)  
**2400**

Panel Thickness (mm)  
**19+ (standard) / 32+ (zero clearance)**

Typical Layouts	Runs Of 120A Top Track	Top Hanger Selection		Bottom Guidance Selection					Optional Hardware can be adjusted based upon individual applications			
		57SS/EN Standard Hanger	66ISS/EN Zero Clearance Hanger	106E/94 Door Mounted Guides	106A/94 Wall Mounted Guide (Internal)	10IN Sawcut Floor Guide (Internal)	55G Captive Nylon Floor Guide Set (Internal)	94P Runs Of Bottom Guide Channel	924-CA48 Interlock	B4742SS Door Stop	456R Flush Bolts Locking or Non-Locking	401 Flush Pulls
1 Door Sliding	1	2	2	2	1	1	1	1	1	1	1	2
2 Doors Bi-Parting	1	4	4	4	2	2	2	1	2	2	2	4
2 Doors Bi-Passing	2	4	4	4	N/A	2	2	2	0	0	2	2
3 Doors Bi-passing	2	6	6	6	N/A	3	3	2	0	0	3	4
2 Door Telescopic	2	4	4	4	1	N/A	N/A	2	2	2	2	3
3 Door Telescopic	3	6	6	6	2	N/A	N/A	3	3	3	3	4
Additional Notes	Available in lengths of 2000mm, 2500mm, 3000mm, 3500mm, 4000mm, 5000mm and 6000mm			2no Guide rollers place at each end of the door  You will also require 94P guide channel to recess into the floor for the whole width of the opening	Single wall mounted guide placed so that it is always in contact with the door and hidden from view. Requires 94P guide channel to be inverted and recessed into bottom of the door. Internal use only	Single floor mounted guide placed so that it is always in contact with the door and hidden from view. Requires a sawcut groove on the bottom of the door. Internal use only	Captive guide set that is placed either side of the door if no door preparation is required	Available in lengths of 1000mm, 2000mm, 2500mm, 3000mm, 3500mm, 4000mm, 5000mm and 6000mm		Required to both stop the door and for telescopic panels to catch the doors when opening		

### Standard Hanger End Elevation

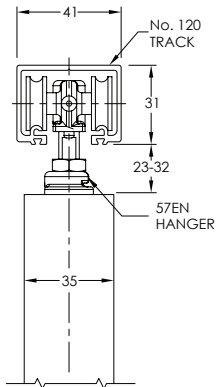

### Zero Clearance Hanger Details

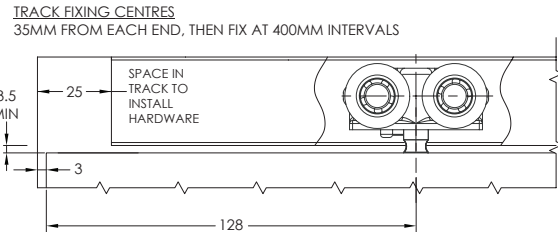

### Bottom Guide Alternatives

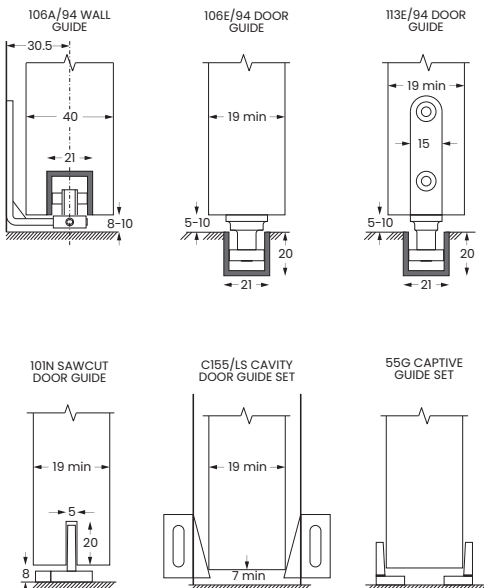

### PANEL PREPARATION AND INSTALLATION

1. PREPARE PANEL FOR MOUNTING PLATE.

2. FIT MOUNTING PLATE WITH SCREWS SUPPLIED

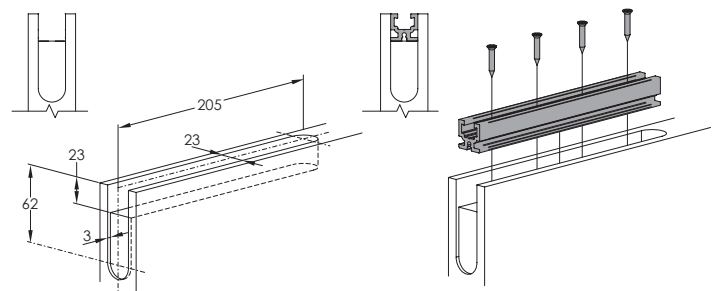

### ASSEMBLY

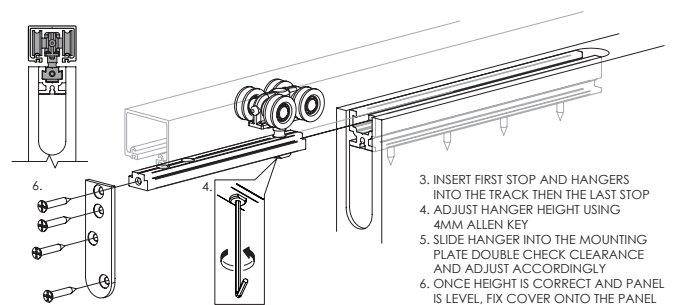

3. INSERT FIRST STOP AND HANGERS INTO THE TRACK THEN THE LAST STOP  
4. ADJUST HANGER HEIGHT USING 4MM ALLEN KEY  
5. SLIDE HANGER INTO THE MOUNTING PLATE DOUBLE CHECK CLEARANCE AND ADJUST ACCORDINGLY  
6. ONCE HEIGHT IS CORRECT AND PANEL IS LEVEL, FIX COVER ONTO THE PANEL