



286 Dual Point Locking

Flush Bolt Alternative

The 286 Dual Point Locking System, specifically designed for timber folding doors or window panels, serves as a highly efficient alternative to flush bolts. The system minimises the preparation needed on the door face, resulting in a more visually appealing design.

When door heights exceed 2500mm, operating flush bolts at the top of the door may pose challenges. Traditionally, flush bolts with lengths of 600mm or even 1000mm have been used; however, they often appear visually intrusive.

The 286 System facilitates the operation of doors with a height of up to 3500mm using a single, streamlined, and lockable handle. This handle is centrally located at the same height as standard lever hardware. The door preparation is executed along the edge, ensuring that only the handle is visible when the door is in a closed position.

Please note this system is intended to serve as a replacement for Flush Bolts and should not be utilised as a substitute for a high-security Multipoint Locking System.



Rod Kit Options

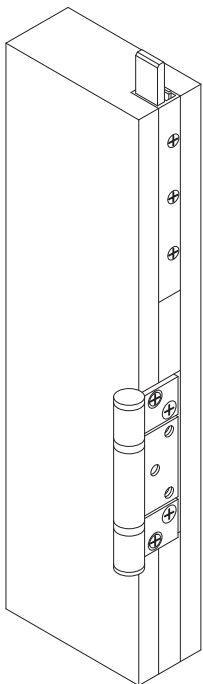

Kit Type "H"
Non-Mortice Hinge
Intermediate Rod Kits

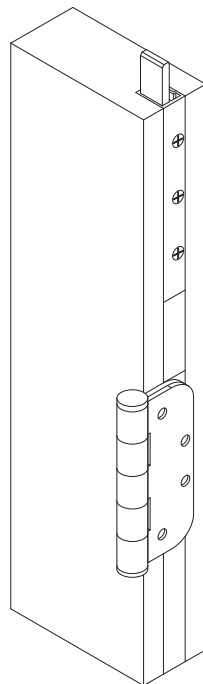

Kit Type "T"
Radius Mortice Hinge
Intermediate Rod Kits

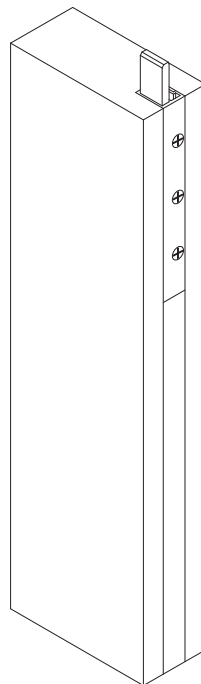

Kit Type "X"
End Panel
Rod Kits

All kit options are available in either 2500mm max or 3500mm max sizes. Gearbox and handles sold separately. Hinges not included as they form part of the Folding Door Hardware System

Additional Hardware

Handle currently only available in
Satin Stainless and Polished
Stainless



286L-40
Locking Handle Set
including Cylinder and 3
keys (2no standard and
1 short as above).



286 Lock Body
35mm or 45mm Backset
options available

Maximum Weight (kg)
100

Maximum Width (mm)
1000

Maximum Height (mm)
3500

Panel Thickness (mm)
44-70

286 Dual Point Locking

Flush Bolt Alternative

Rod Kit Variants	Lengths Available	286TD Lock Body	286L-40 Locking Handle
Intermediate Panel Non Mortice Hinge (H)	286-25HS = 2500mm 286-35HS = 3500mm	286TD/35 = 35mm Backset 286TD/45 = 45mm Backset	Satin Stainless (SS) Polished Stainless (PS) Includes; 2no Standard Keys 1no Short Key
Intermediate Panel Radius Mortice Hinge (T)	286-25TS = 2500mm 286-35TS = 3500mm		
End Panel No Hinge (X)	286-25XS = 2500mm 286-35XS = 3500mm		

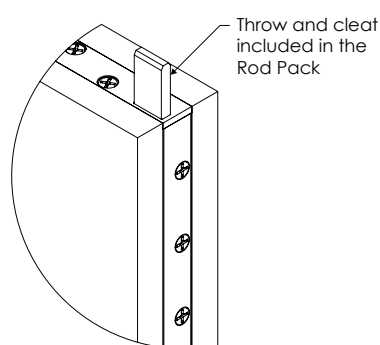
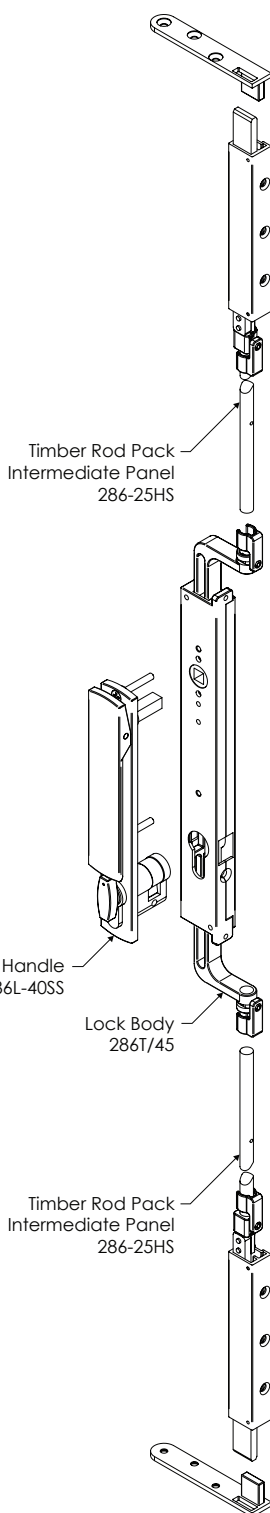
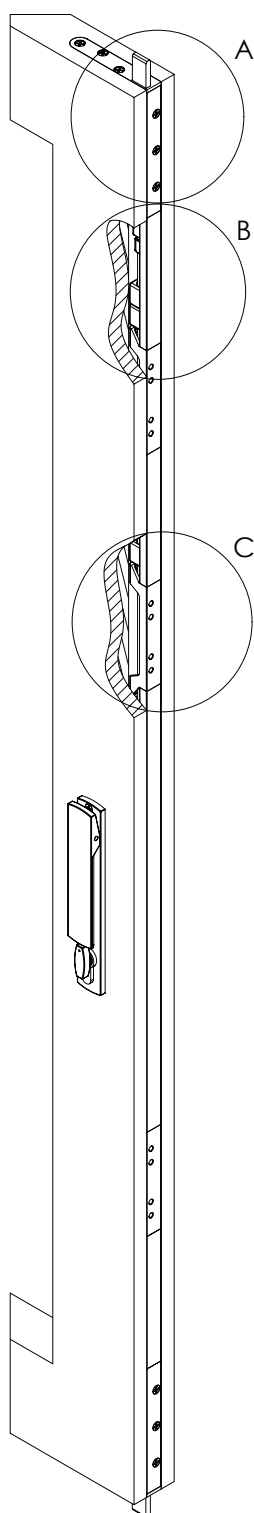

A. 22mm throw of 5x15mm SS bar is checked into the door neat and secure

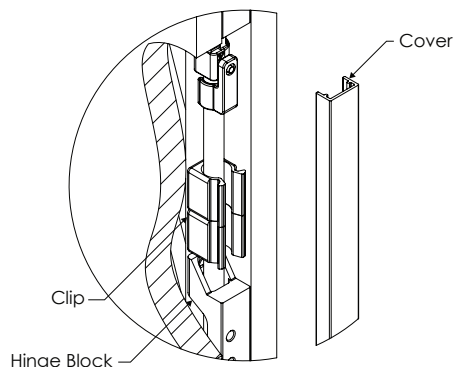

B. Aluminium cover strip dresses the edge of the door with the aid of clips in between hinge blocks

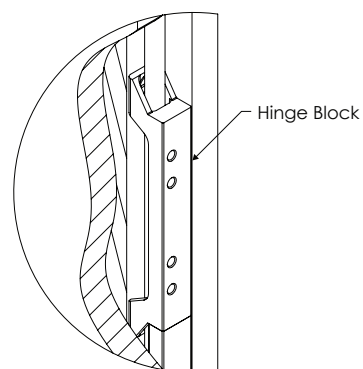

C. Hinge Blocks allow the rods to operate within the edge of the door without being impeded by hinge fixings